

CONDITIONALLY APPROVED THE PLAN AND NOTICE REGARDING INSPECTION OF FOUNDATION & ROOF CASTINGS OF BUILDING ATTACHED

Valid for Three Years
From the Date of 11-2-21
Sanctioned on 11-2-21

Note: Structural Details shall be followed as per Approved Master Copy.

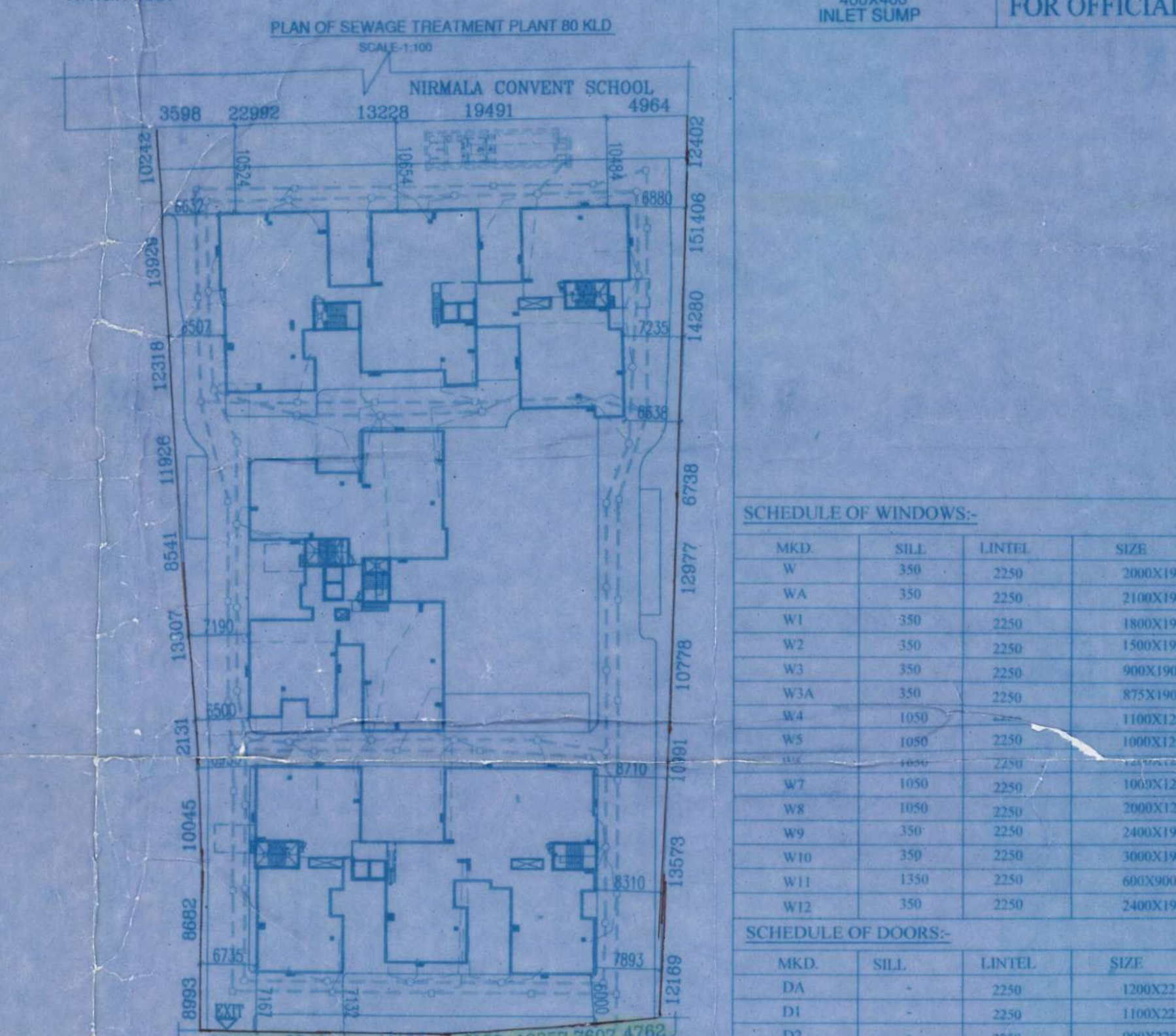
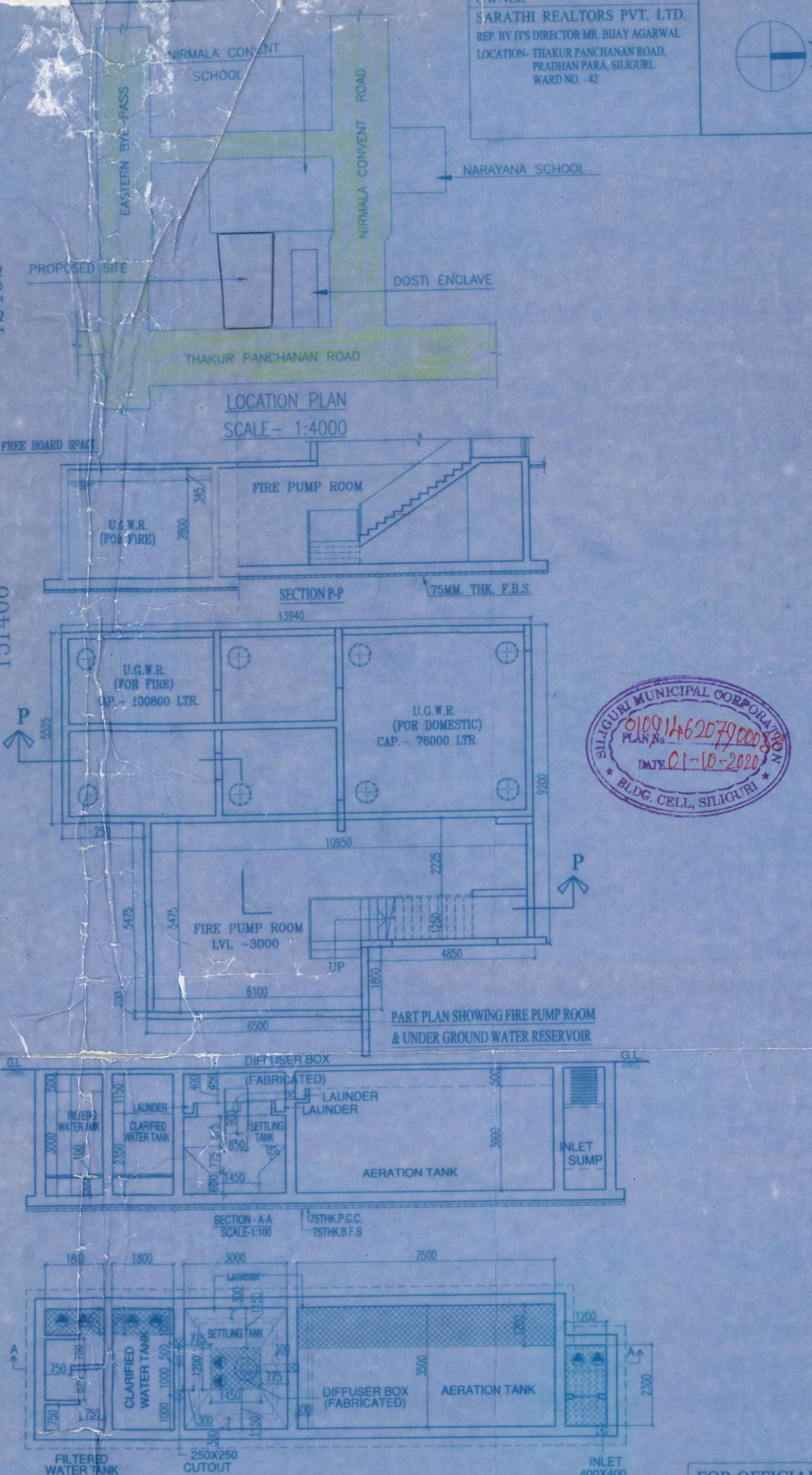
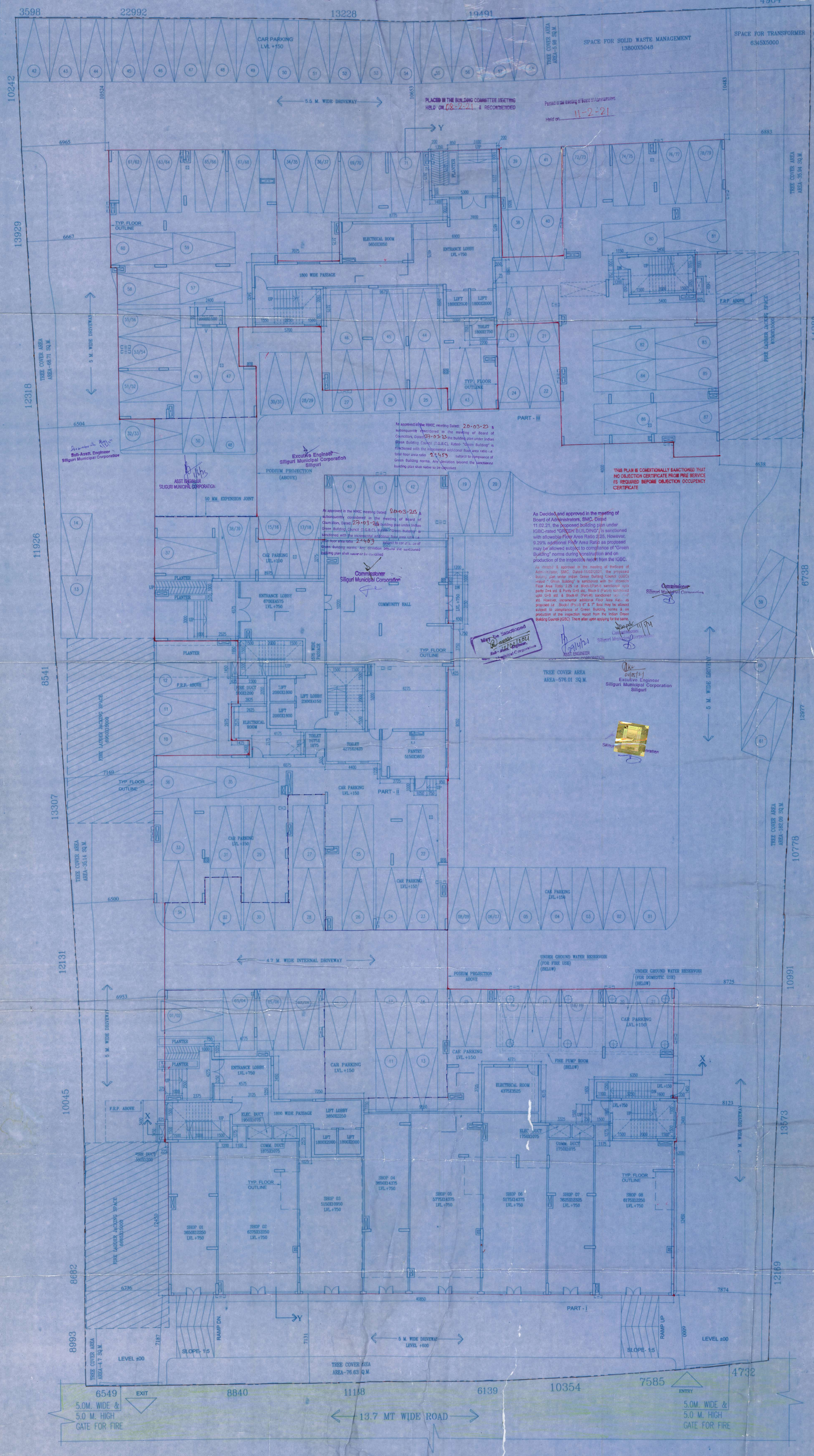

SCHEDULE OF WINDOWS

NO.	NO. OF WINDOWS	LEVEL	SIZE
W1	308	25th	2000x1400
W2	226	25th	2100x1400
W3	226	25th	2100x1400
W4	226	25th	2100x1400
W5	226	25th	2100x1400
W6	226	25th	2100x1400
W7	226	25th	2100x1400
W8	226	25th	2100x1400
W9	226	25th	2100x1400
W10	226	25th	2100x1400
W11	226	25th	2100x1400
W12	226	25th	2100x1400
W13	226	25th	2100x1400
W14	226	25th	2100x1400
W15	226	25th	2100x1400
W16	226	25th	2100x1400
W17	226	25th	2100x1400
W18	226	25th	2100x1400
W19	226	25th	2100x1400
W20	226	25th	2100x1400
W21	226	25th	2100x1400
W22	226	25th	2100x1400
W23	226	25th	2100x1400
W24	226	25th	2100x1400
W25	226	25th	2100x1400
W26	226	25th	2100x1400
W27	226	25th	2100x1400
W28	226	25th	2100x1400
W29	226	25th	2100x1400
W30	226	25th	2100x1400

AREA STATEMENT

APPROVED L.U.C. NO. 1088/2019 DATED 17.12.2019
 1. LAND AREA AS PER DEED = 6088.00 SQ.M.
 2. LAND AREA AS PER SITE = 6088.00 SQ.M.
 3. AREA OF ROAD = 10.00 SQ.M.
 4. AREA OF OPEN SPACE = 10.00 SQ.M.
 5. AREA OF TREE COVER = 10.00 SQ.M.
 6. AREA OF UNDERGROUND WATER RESERVOIR = 10.00 SQ.M.
 7. AREA OF OTHER AREAS = 10.00 SQ.M.
 8. TOTAL AREA = 6108.00 SQ.M.

SIGNATURE OF OWNER

SARATHI REALTORS PVT. LTD.
 DIRECTOR

SIGNATURE OF STRUCTURAL ENGINEER

SANJIV PAREKH
 M.E. (STRUCT. ENGRG.)
 REG. NO. 101822/24

SIGNATURE OF ARCHITECT

AGRAWAL & AGRAWAL
 ARCHITECTS